



DESCRIPTION

**G058P**

Lockable device for closed position for steel lever.

The G058P locking device prevents unauthorized openings. The locking device is attached over the stem and handle. It is hold in place with an Allen screw that is screwed into the center of the stem. With the padlock in place, the Allen screw is not accessible, making the valve tamper proof. It can fit on every 51, 51CE, G51 or G61 series ball valve.

MATERIALS

<b>Toothed sector</b>	CW617N (DIN 50930 part.6) CuZn40Pb2
<b>Revolving sleeve</b>	CW614N (DIN 50930 part.6) CuZn39Pb3
<b>Spring</b>	Stainless steel
<b>Allen screw</b>	Steel
<b>Padlock</b>	Steel with Delta Protèkt treatment
<b>Spacer</b>	CW614N (DIN 50930 part.6) CuZn39Pb3
<b>Collar</b>	Rubber

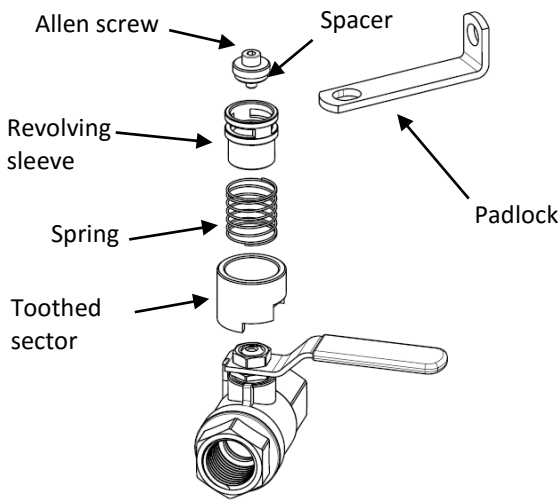

DIMENSIONS

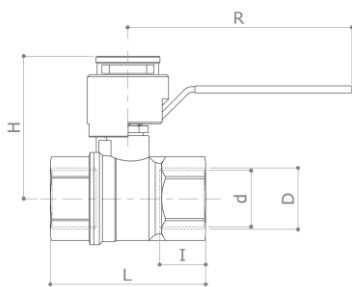

D	1/4"	3/8"	1/2"	3/4"	1"	1 1/4"	1 1/2"	2"	2 1/2"	3"
d	10	10	15	20	25	32	40	50	63	76
H	47	47	50	57	73.5	78.5	92	99	126	136
I	11.5	12	17	18	21.5	23.5	23.5	28	32	34.5
L	46	46	62	69	84	96	106	127	154	180
R	75	75	75	95	120	120	150	150	200	200
Poids [g]	210	210	300	440	830	1190	1610	2410	4110	6020

Dimensions in mm referred to the 058P installed on the 51 series ball valve.

All threads are conform to ISO 7

COMPATIBILITY

G058P	Size 51/G51/G61 series	Size 51CE series
Type 1	1/4" - 3/8" - 1/2"	1/2"
Type 2	3/4"	3/4" - 1"
Type 3	1" - 1 1/4"	1 1/4"
Type 4	1 1/2" - 2"	1 1/2" - 2"
Type 5	2 1/2" - 3"	-